

GBC FuturoPunch Pro

Installation Instructions

1.1

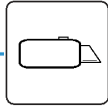

1.2

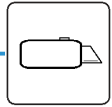

1.3



1.4



1.5



1.6



1.7



1.8



1.9



1.10



1.11

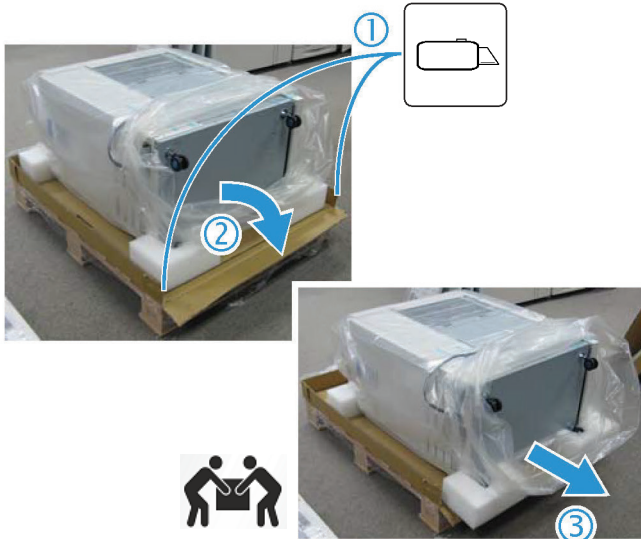

1.12



1.13

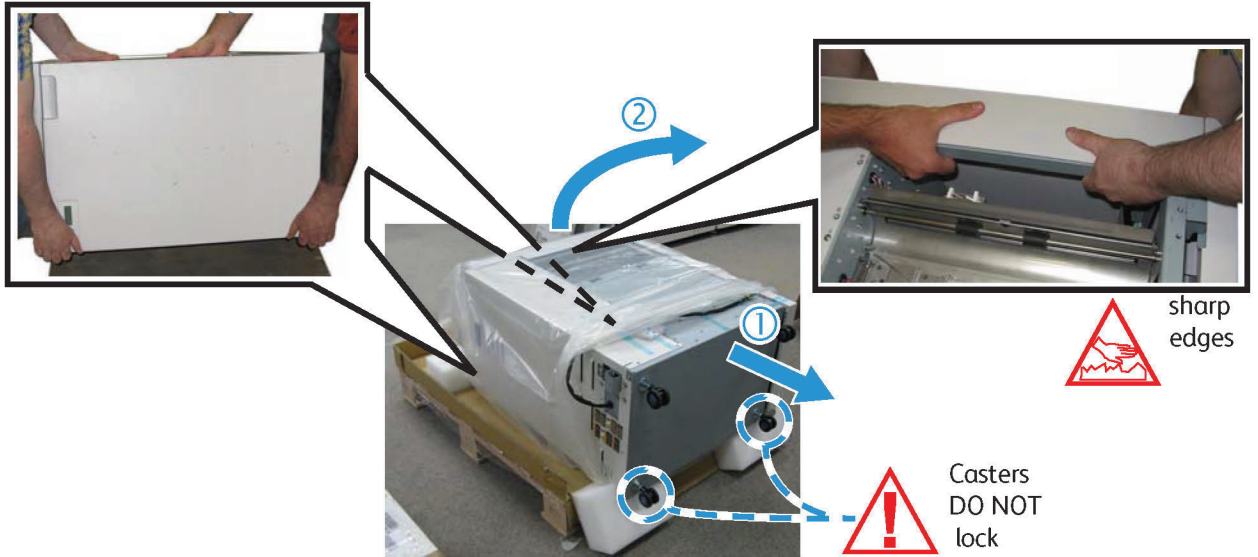
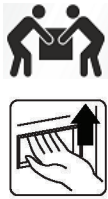

1.14



1.15



1.16

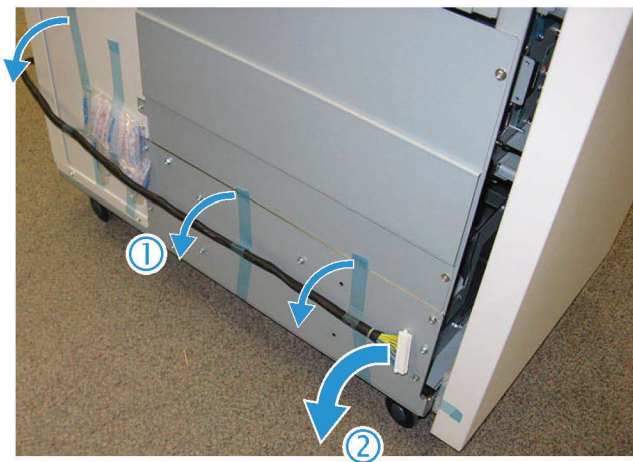

1.17

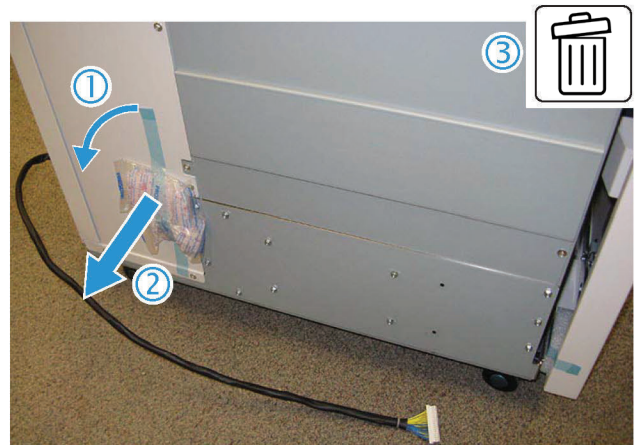

1.18



1.19

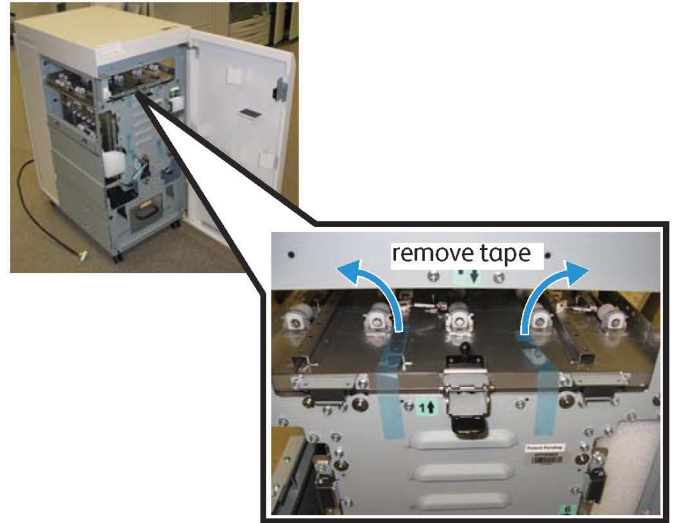

1.20

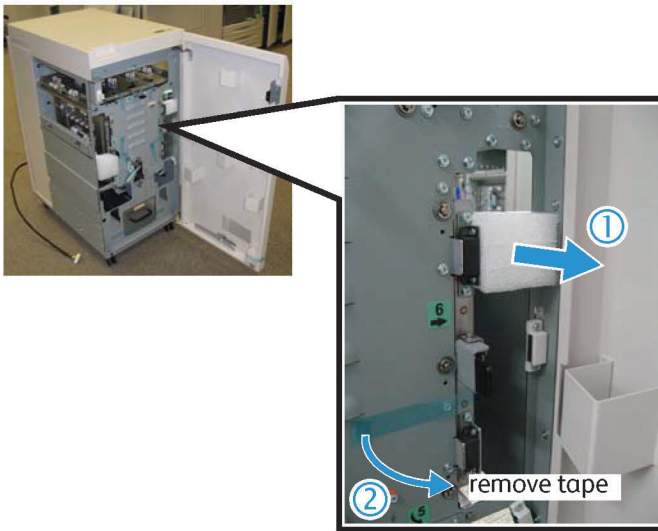

1.21

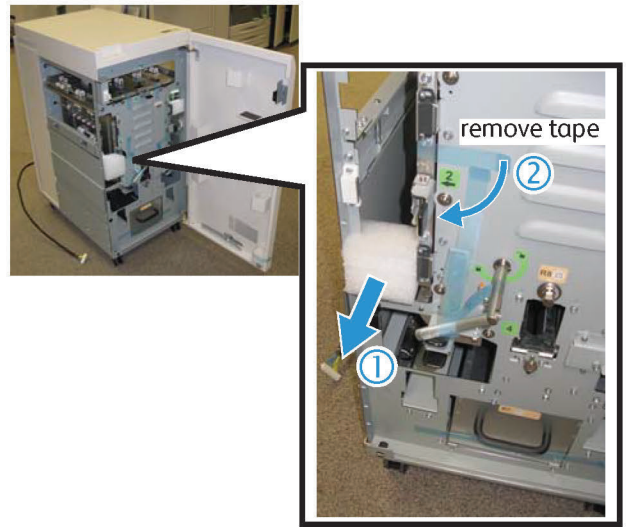

1.22

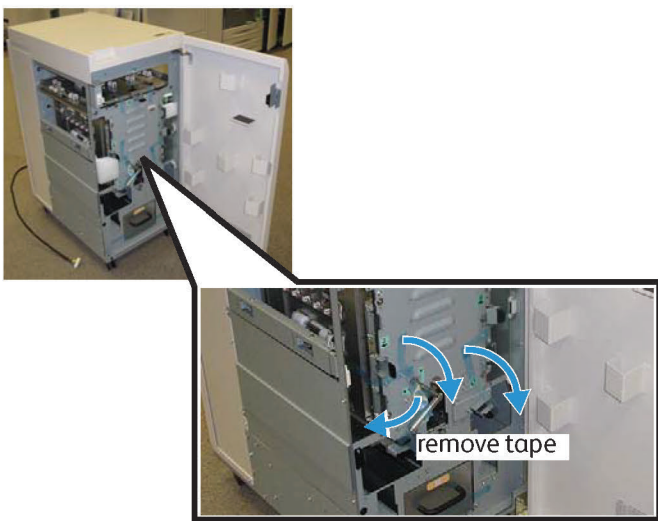

1.23

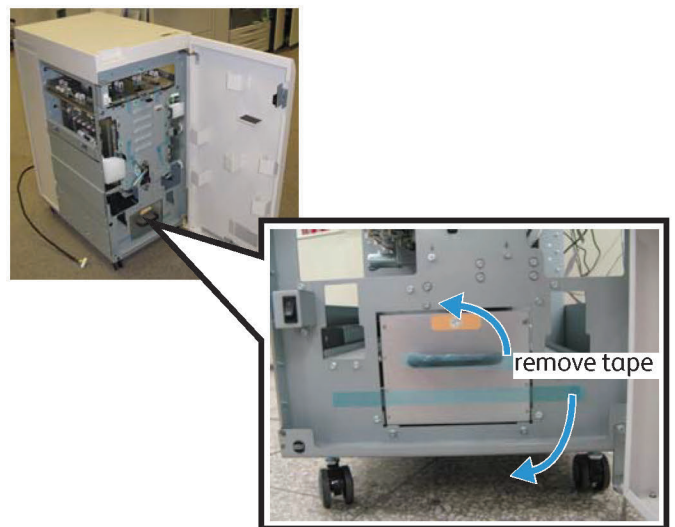

1.24

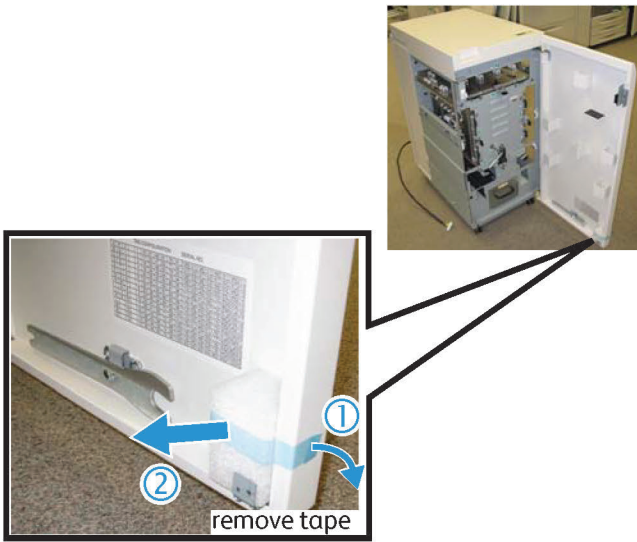

1.25



1.26

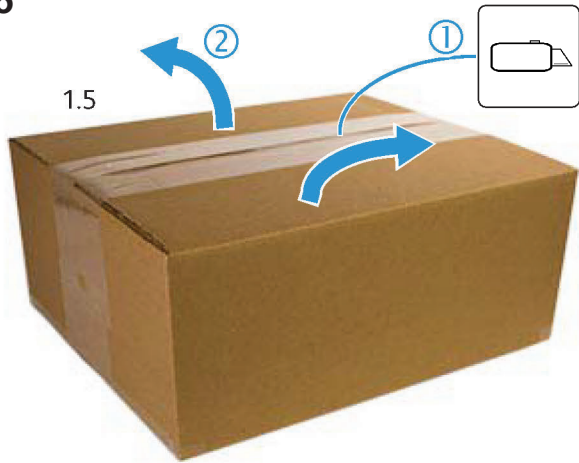

1.27



1.28



1.29



1.30

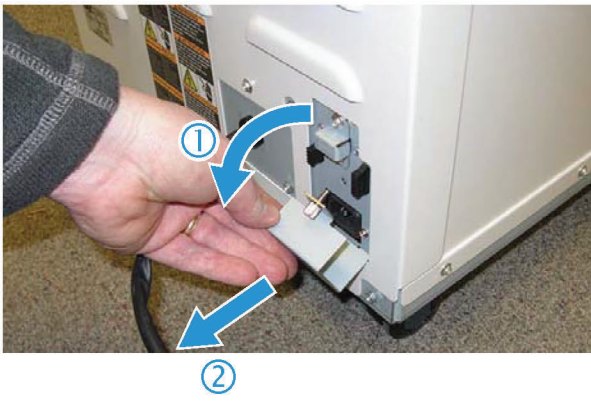

1.31



1.33



1.32



1.33

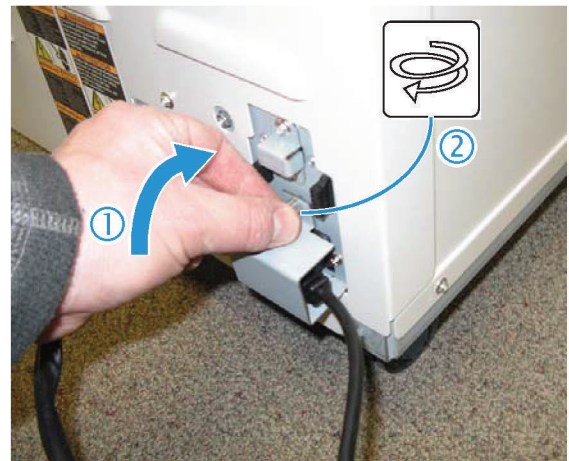

1.34

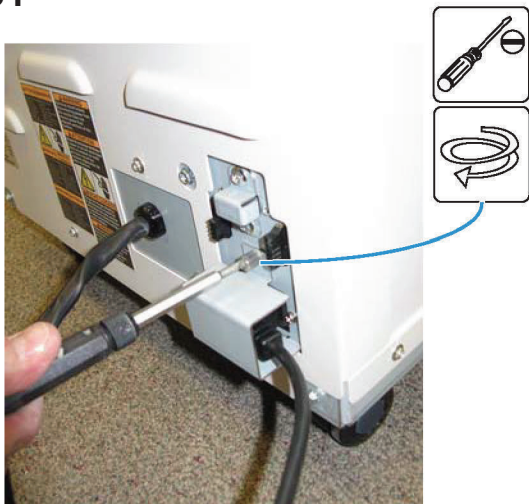

1.35

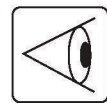

Check levelness with upstream module, if applicable.

1.36 If leveling of module is required

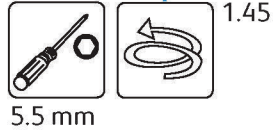
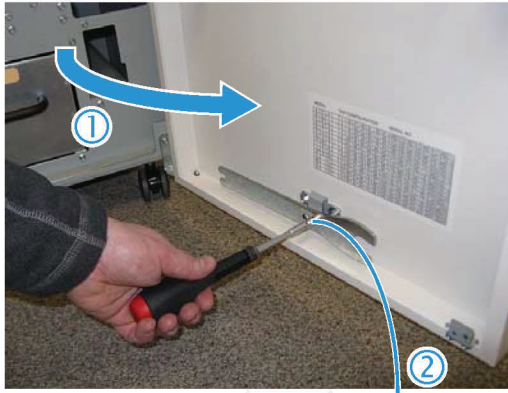

1.37

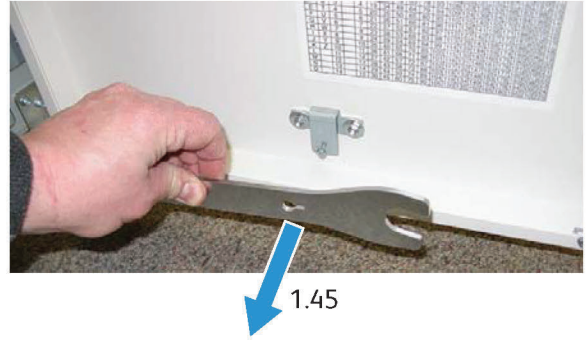

1.38

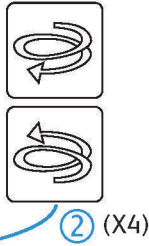
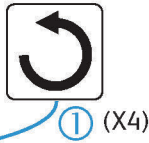
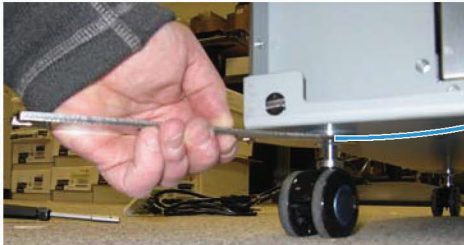

1.39

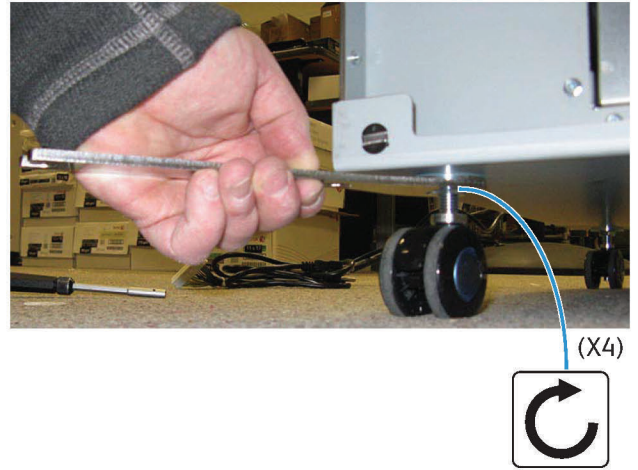

1.40

