

# GBC® AdvancedPunch™ Plus Installation Instructions

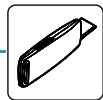

# 1.0 1.1 QC5 (AMS) / 450S03231 (EMEA)



## 1.2

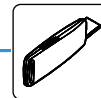

## 1.3



## 1.4



## 1.5



1.6

③

④

①

② 3.1

## 1.6

7715803



4.7

702P09503



②

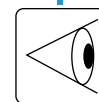

1.7 - 4.8



1.7



1.8



1.9



1.10



1.11



1.12

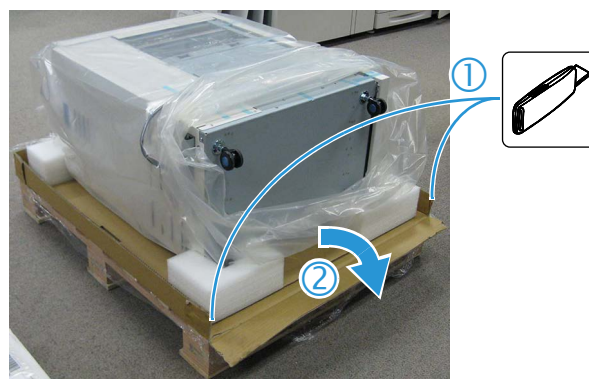



1.13



1.14

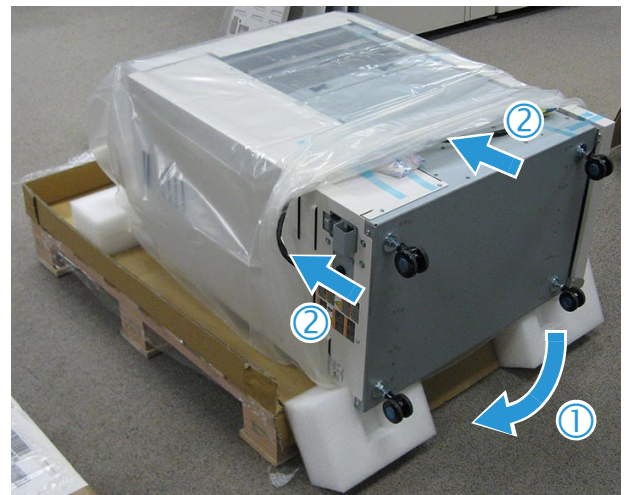

1.15



Casters  
DO NOT  
lock



1.16

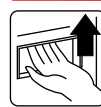

1.17



2.0 2.1



2.2



2.3

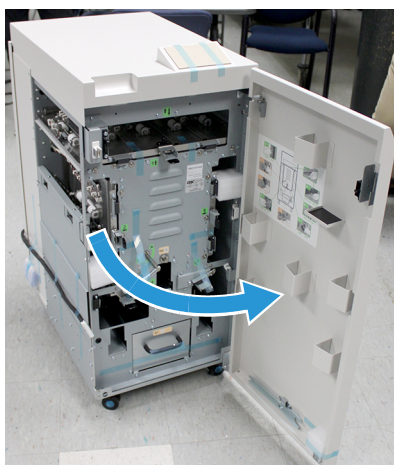

2.4

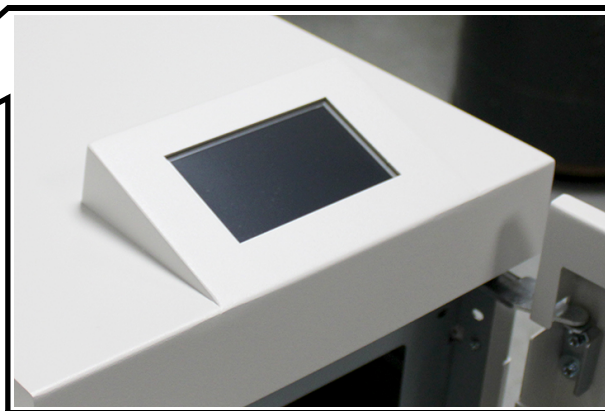
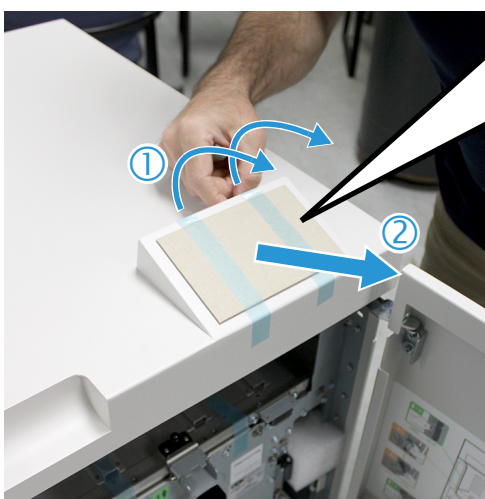



2.5

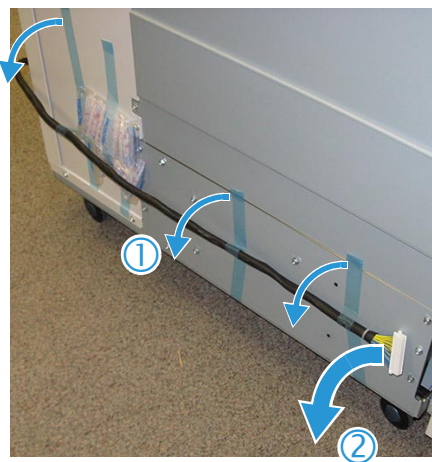

2.6

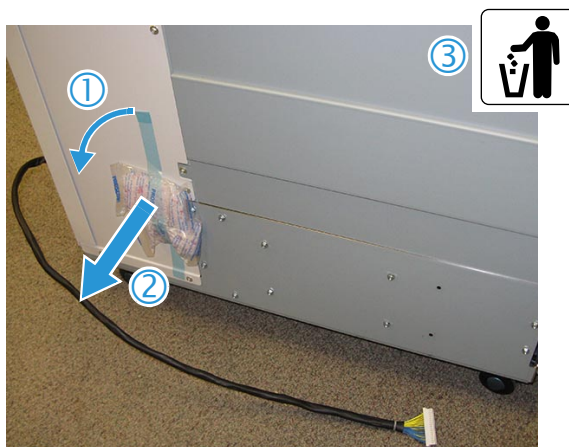

2.7

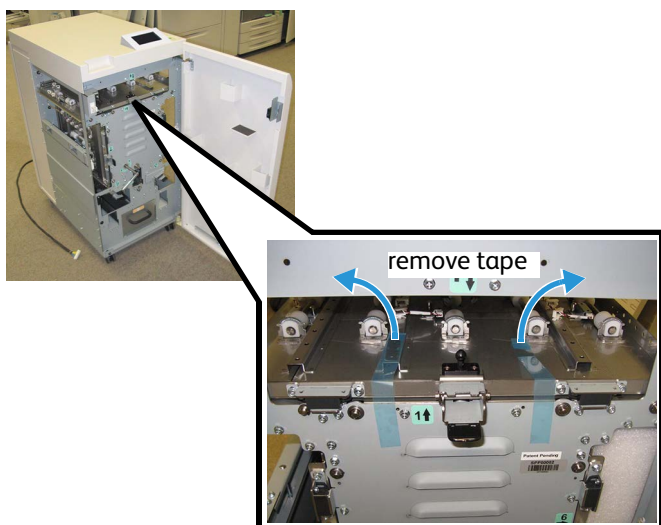

2.8

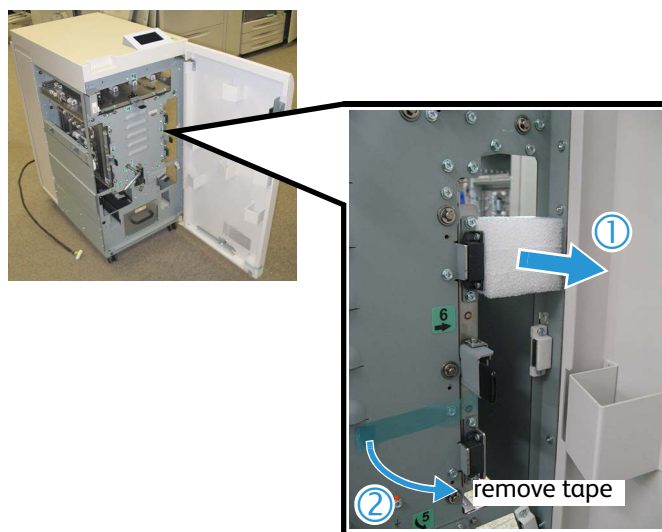

2.9

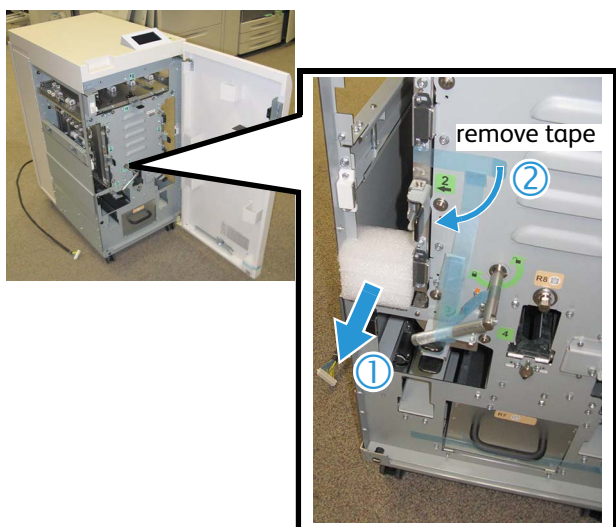

2.10

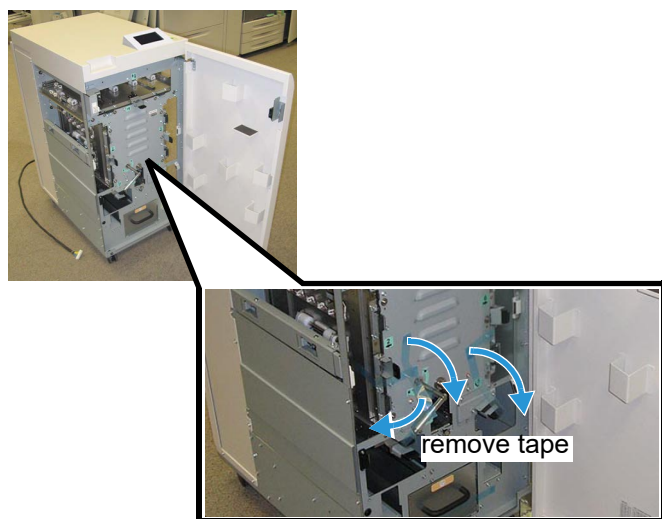

2.11

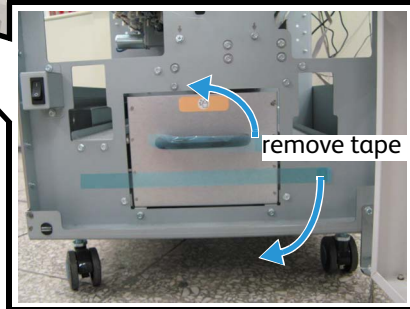
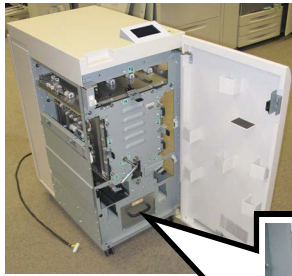

2.12

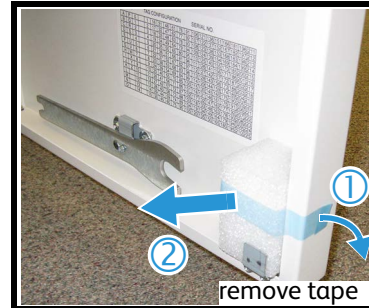
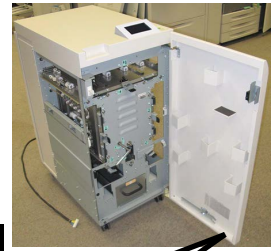

2.13





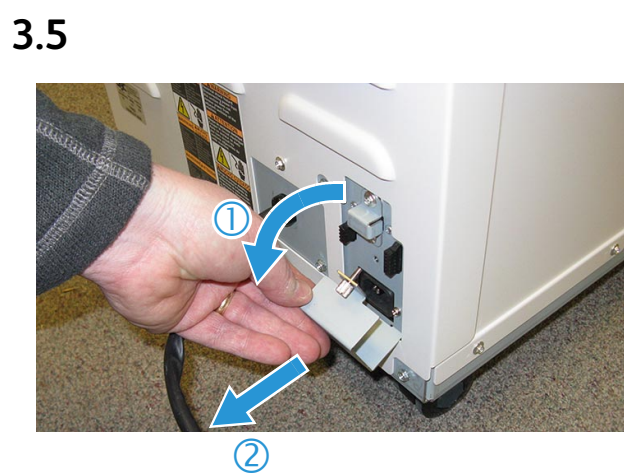
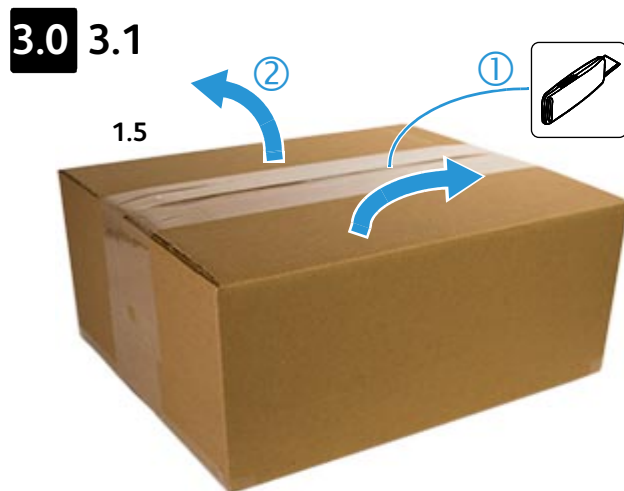

3.7



3.8

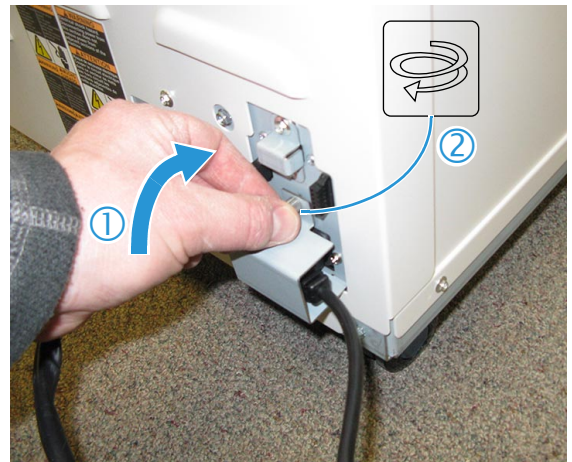

3.9

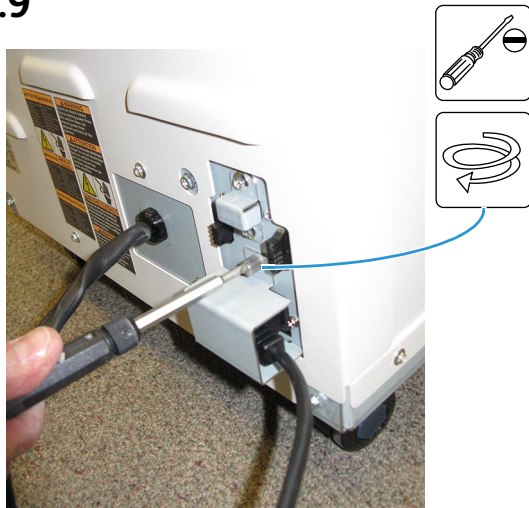



## 4.0 4.1

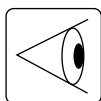

Check levelness with upstream module, if applicable.

## 4.2 If leveling of module is required

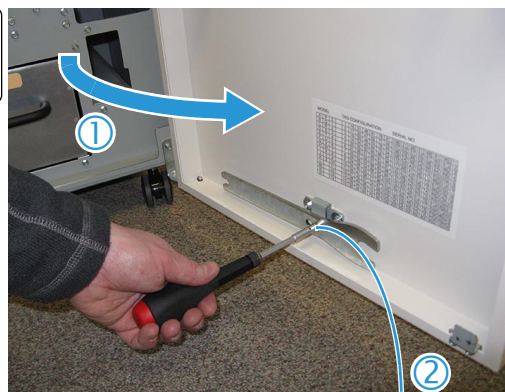

4.6

## 4.3



4.6

## 4.4

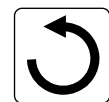
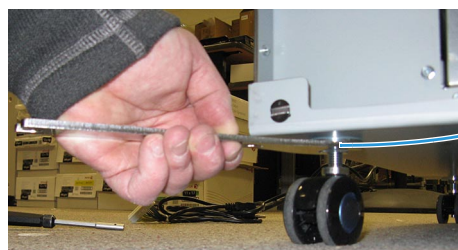

① (X4)



② (X4)



## 4.5

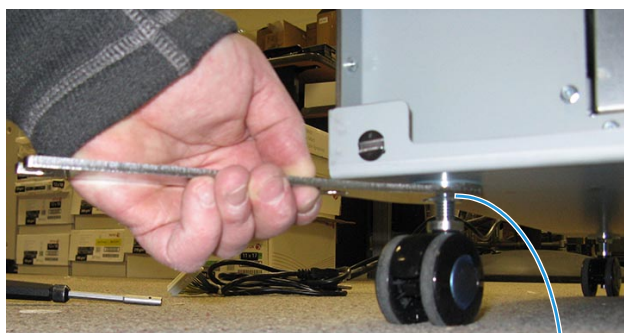

(X4)

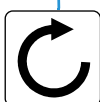

## 4.6



②  
4.3



① 4.2





## 5.0 5.1



## 5.2



Refer to QC5/ (AMS) / 450S03231 (EMEA) docking process within corresponding Installation Instructions or Carrier Manual



## 5.3

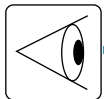

QE4 / 450S03229



702P0XXXX or 607E0XXXX

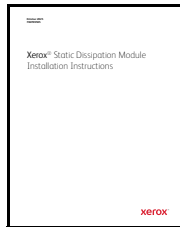

702P09505



## 5.4

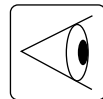

QF8 / 450S03230

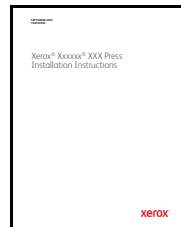
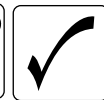

702P0XXXX or 607E0XXXX



702P09504



## 5.5

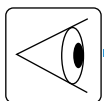

EEQ / 450S03167, GZ8 / 450S03220

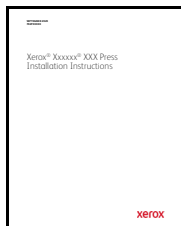

702P0XXXX or 607E0XXXX

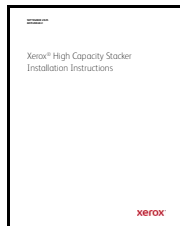

607E28840



## 5.6

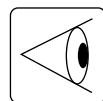

QAK / 450S03166

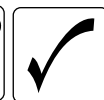

702P0XXXX or 607E0XXXX



607E37790



## 5.7

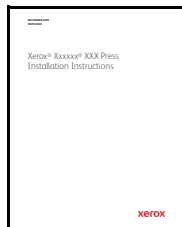
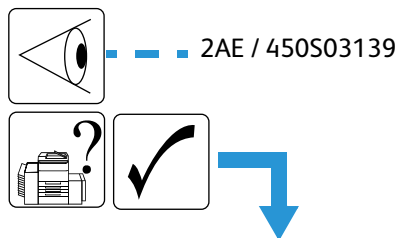

702P0XXXX or  
607E0XXXX

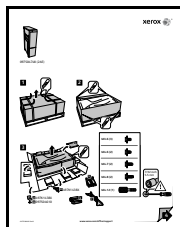

607E19060

## 5.8

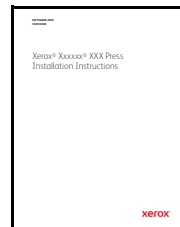
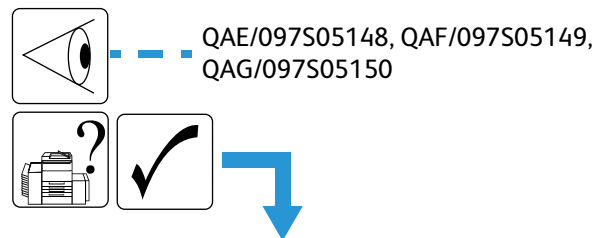

702P0XXXX or  
607E0XXXX

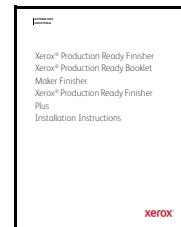

607E37780

